



GRASSROOTS
REALTY GROUP

587-777-7276
yuri@grassrootsrealtygroup.ca

TWP 360 RR. 43
Rural Clearwater County, Alberta

MLS # A2257013

\$4,600,000

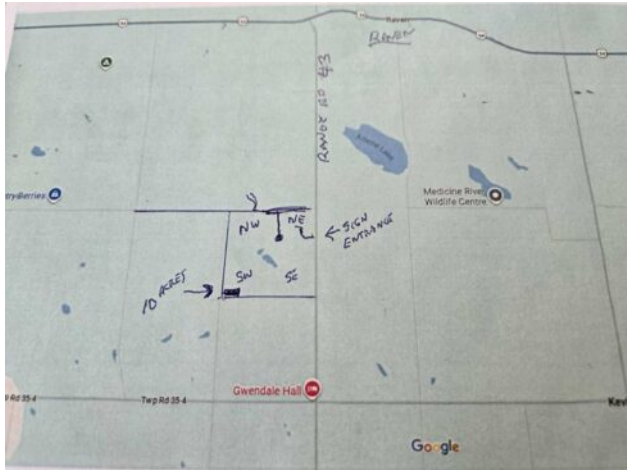

Division:	NONE	
Cur. Use:	Grazing, Hunting, Livestock, Pasture	
Style:	-	
Size:	0 sq.ft.	Age: -
Beds:	-	Baths: -
Garage:	-	
Lot Size:	-	
Lot Feat:	-	

Heating:	-	Water:	-
Floors:	-	Sewer:	-
Roof:	-	Near Town:	Spruce View
Basement:	-	LLD:	33-35-4-W5
Exterior:	-	Zoning:	AG
Foundation:	-	Utilities:	-
Features:	-		

Major Use: Land Only

FULL SECTION IN ONE BLOCK. FIVE TITLES TOTALLING 644 ACRES ALL IN PASTURE, TREES, RECREATION. EXTREMELY RARE FIND LOCATED WEST OF INNISFAIL , BETWEEN SPRUCE VIEW AND CAROLINE.