



GRASSROOTS
REALTY GROUP

587-777-7276
yuri@grassrootsrealtygroup.ca

**358 Saddlecrest Circle NE
Calgary, Alberta**

MLS # A2313627

\$380,000

Division: Saddle Ridge

Lot Size: 0.08 Acre

Lot Feet: Back Yard, City Lot

By Town: -

LLD: -

Zoning: R-G

Water: -

Sewer: -

Utilities: -

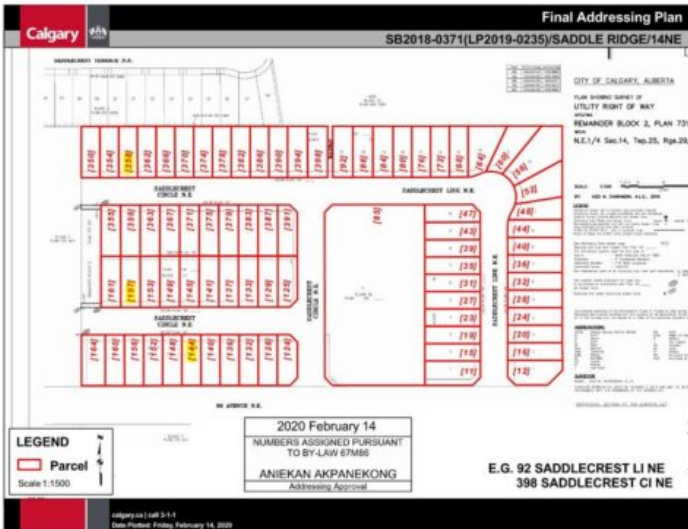

Prime Vacant Lot Opportunity in Saddle Ridge, Calgary! Build your dream home or investment property in one of Calgary's fastest-growing communities. This vacant lot offers an excellent location surrounded by schools, parks, shopping, transit, and all major amenities. Whether you're a builder, investor, or future homeowner, this is your chance to secure land in the highly desirable Saddle Ridge neighborhood. Great location. Strong future potential. Endless possibilities. Contact me today for more details before this opportunity is gone!